

Library

Ceiling height

Max 4.1m (13'5")

Min 3.372m (11'1")

Total approximate floor area
67.68 sq mt (728.5 sq ft)

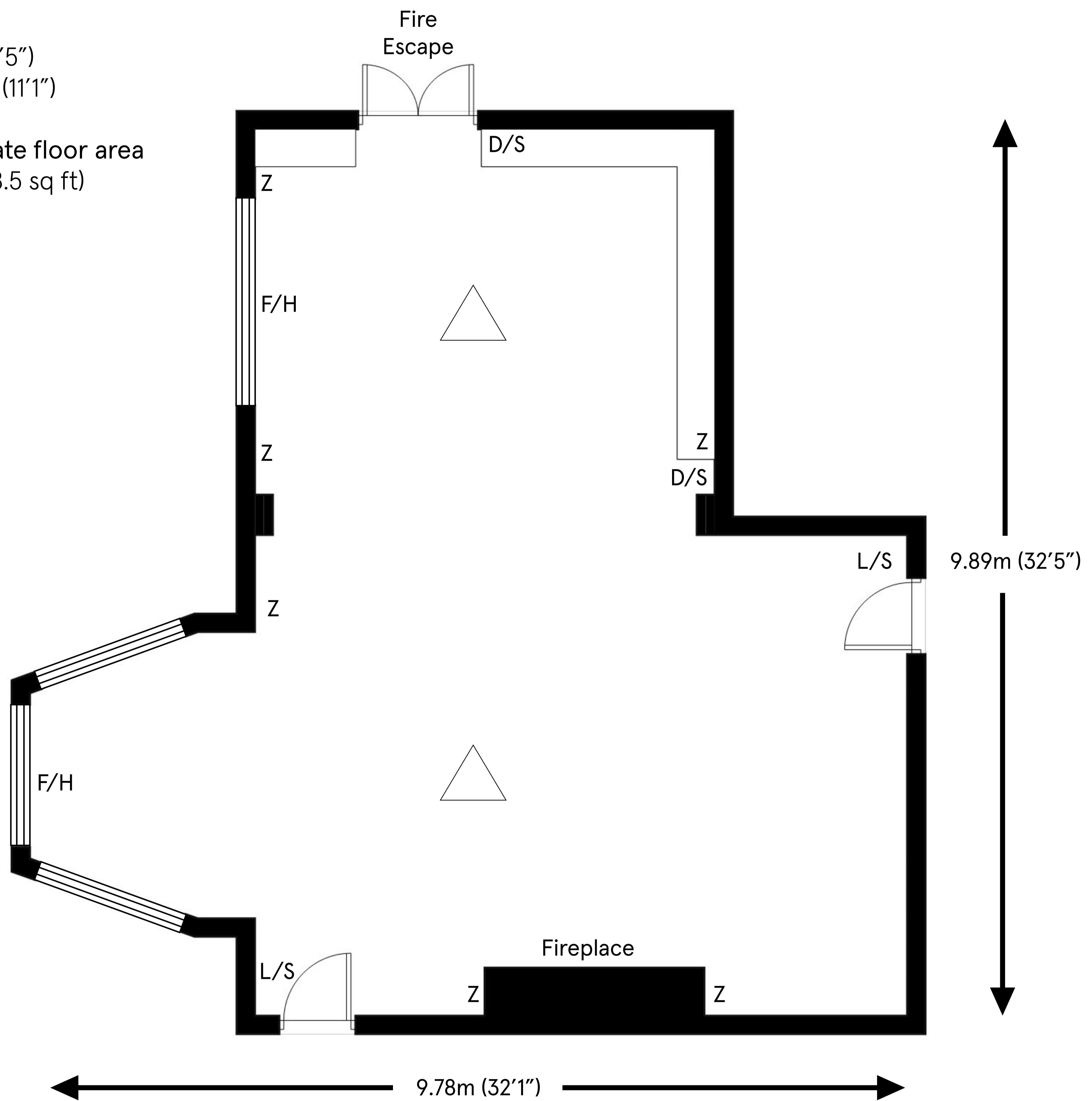

- Key:
- Z 13 Amp Sockets
 - L/S Light switch
 - D/S Dimmer Light Switch
 - F/H Fan/Heater
 - △ Chandelier

For room capacity please refer to the room configuration charts